

M I L L S C O U N T Y

I O W A

26400 W

26600 W

26800 W

27000 W

27200 W

27400 W

27600 W

P L A T T S M O U T H

U P P E R

B E N D

POLLOCK & CASS COUNTY LEVEE

TBM 635.88
PLATTSMOUTH
Pumping Station

C A S S C O U N T Y

N E B R A S K A

60000 N

59800 N

59600 N

59400 N

59200 N

59000 N

58800 N

MISSOURI RIVER BANKS
State Surveyors Office, State of Nebr.
Taken From U.S. Army Engineer Plans
Showing Section Lines, Date 8-1-62
Sheet No. 2 Scale 1" = 400'

Structure Azimuth Line is
Top of Bank

Structure Azimuth Line
is Top of Bank

28 AUG. 1962 24 AUG. 1962
BANK LINES

GRID DIVERGENCE 0°38'49.6"
TRUE AT PLATTE

GRID DIVERGENCE 0°38'49.6"
TRUE AT PLATTE

GRID DIVERGENCE 0°37'21.6"
TRUE AT PLATTE

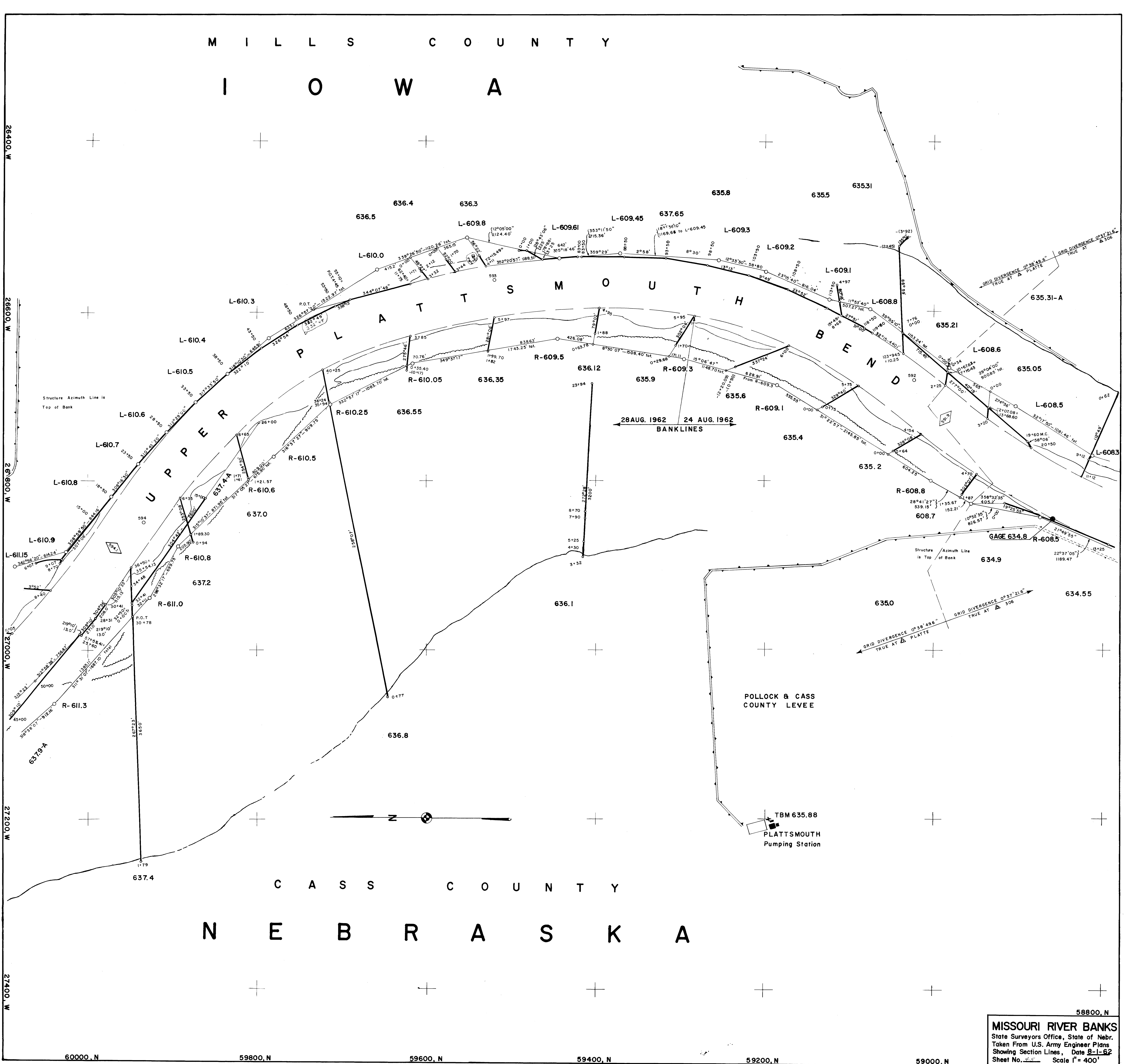
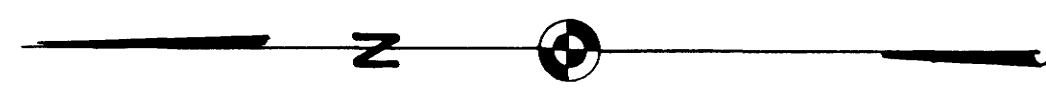

0.6-35
60