

MISSOURI RIVER FLORENCE, NEB. TO SIOUX CITY, IA. TOPOGRAPHIC SURVEY MILE 686.9 TO MILE 690.3

In 51 Sheets (73-123) Sheet No. 80 Scale: 1"=400'

U. S. Engineer Office, Kansas City, Missouri. April 27, 1932

Submitted:	Approved:
Surveyed by: N.W.A. T.J.H.	Checked by: R.H.R.P.S.
Drawn by:	File No.:
Transmitted with Letter or Indorsement dated:	256-80

△ Weston is the origin of coordinate system.
 All azimuths on this sheet referred to true South at Δ 319.
 Grid Divergence = 0°43'31.4"
 Soundings taken April 27, 1932.
 Bank Line & Bars April 27, 1932.
 Elevations referred to Mean Sea Level as zero.
 River Stage above M.L.W. April 27, 3.0
 River Stage above 1930 LWP April 27, 1.5

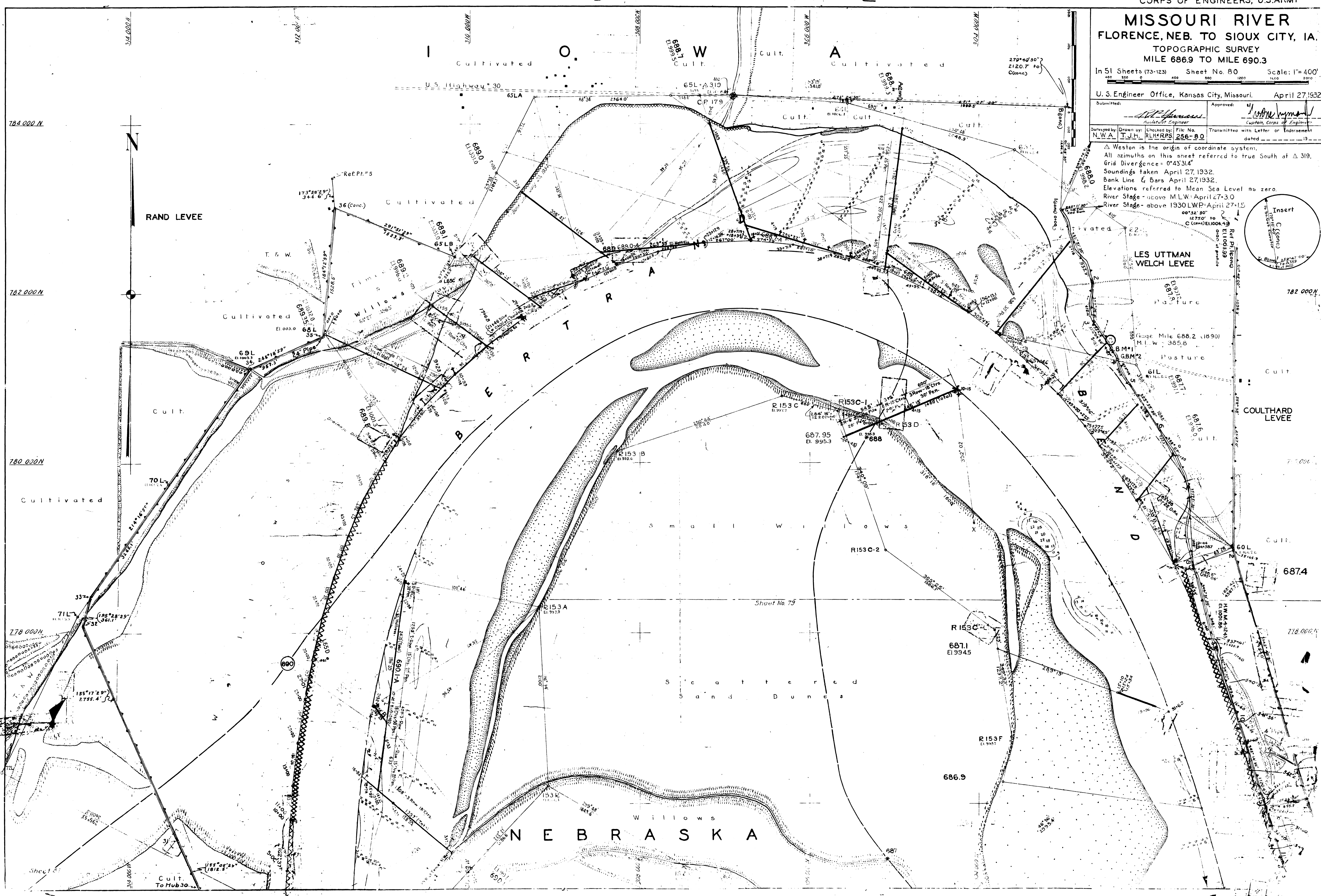
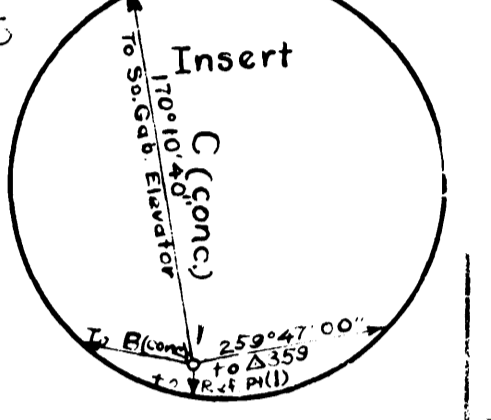

784 000 N

782 000 N

780 000 N

778 000 N

782 000 N

780 000 N

778 000 N

Sheet No. 79

2087