

DEPARTMENT

CORPS OF ENGINEERS, U.S.A.R.

MISSOURI RIVER
FLORENCE, NEB. TO SIOUX CITY,
TOPOGRAPHIC SURVEY
MILE 678.4 TO MILE 680.7
 In 51 Sheets Sheet No. 76 Scale: 1" = 400'

U. S. Engineer Office, Kansas City, Missouri, April 27, 1932
 Submitted by: *[Signature]* Approved: *[Signature]*
 Checked by: *[Signature]* Permitted with Letter of Indorsement
 U.W.A. E.L.H.F.R.S. dated 1932

△ Weston is the origin of the datum system.
 All azimuths on this sheet referred to true South at Δ 315.
 Grid Divergence: 0° 41' 01" D
 Soundings taken April 27-28, 1932
 Bank Line & Bars April 28, 1932
 Elevations referred to Mean Sea Level as zero.

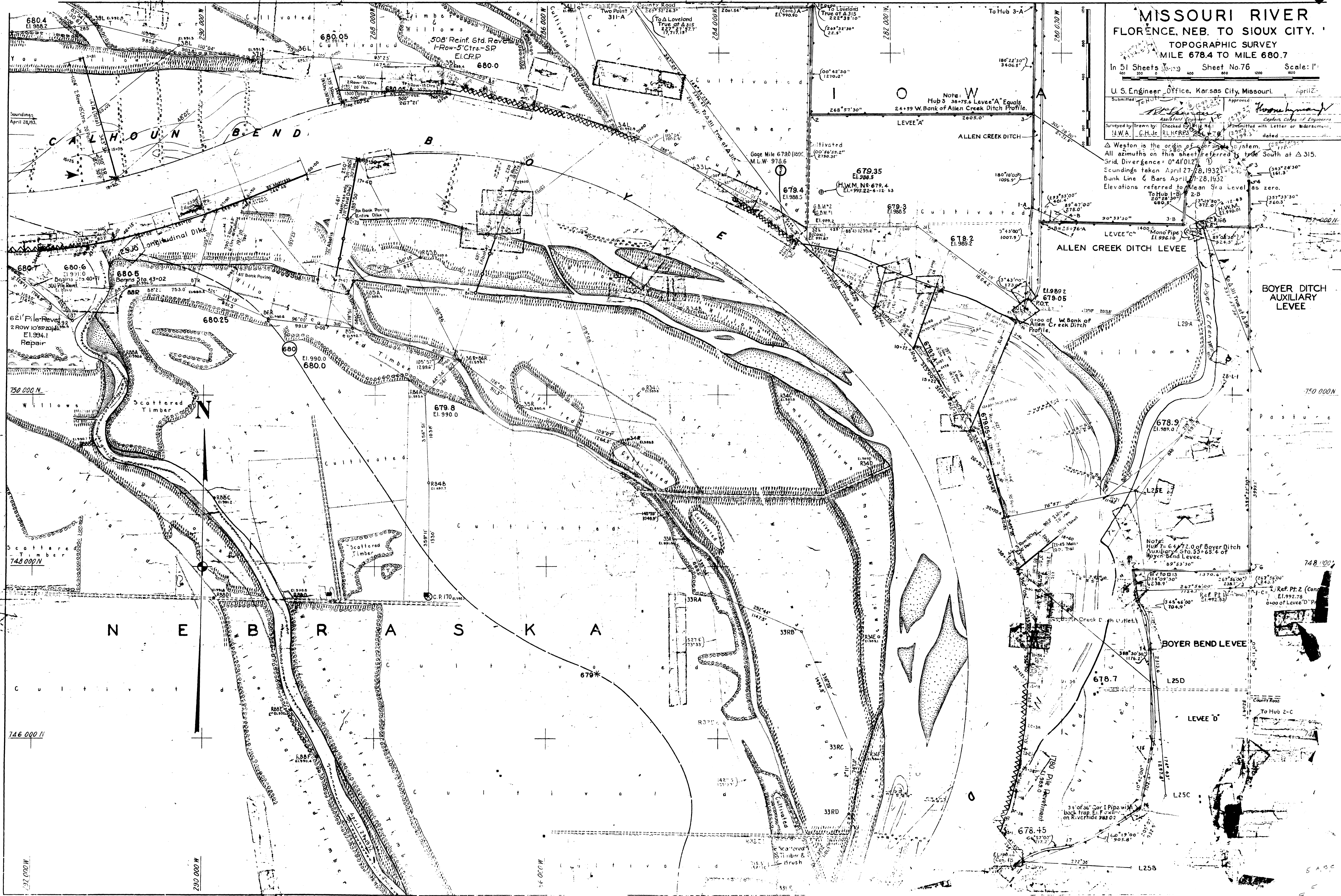

NOTE: Hub 76 64+72.0 of Boyer Ditch Auxiliary Sta. 55+65.4 of Boyer Bend Levee.
 Ref. Pt. 2 (Cont.) El. 992.78
 0+00 of Levee "D" Profile

34" of 4" Cor. I Pipe with back trap El. 992.02 on Riverside 943.02

2101

5 A 9 C