

BLUE PRINT COMPANY
1415 HARNEY STREET
OMAHA NEBR.
BLUEPRINTING
PHOTO COPY &
REPRODUCTIONS
ENGINEERS
ARCHITECTS &
ART MATERIALS

9X 5X
8X 4X
7X

J F M A M J
A E A P A U
N B R R Y N
J A S O N O
U L G P T V E C

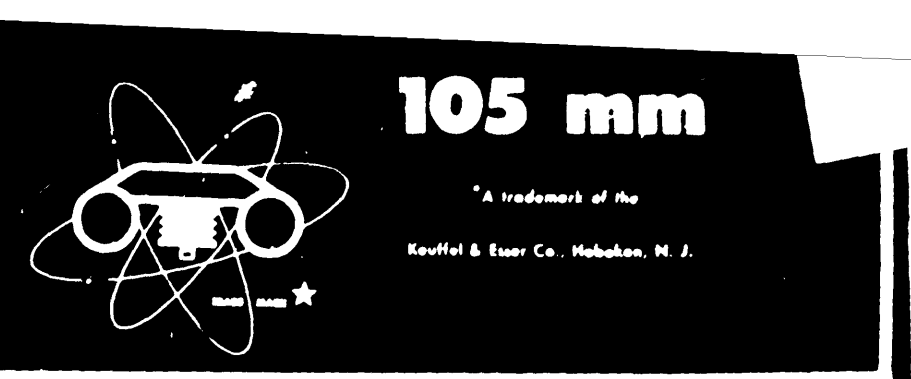

CORPS OF ENGINEERS, U.S. ARMY

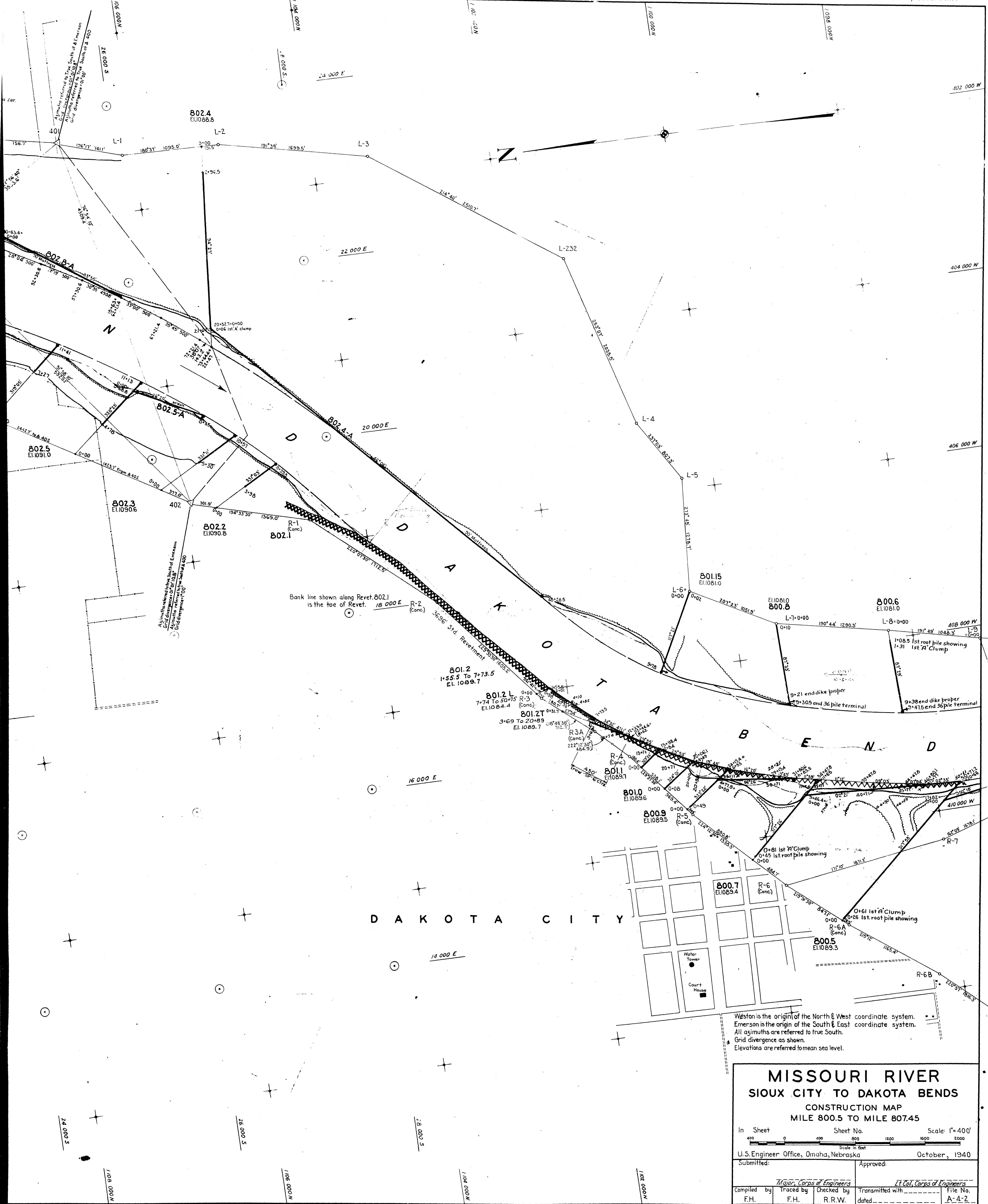

Washington is the origin of the North & West coordinate system.
Emerson is the origin of the South & East coordinate system.
All azimuths are referred to true South.
Grid divergence as shown.
Elevations are referred to mean sea level.

**MISSOURI RIVER
SIOUX CITY TO DAKOTA BENDS
CONSTRUCTION MAP
MILE 800.5 TO MILE 807.45**

In Sheet _____ Sheet No. _____ Scale: 1"=400'
 400 800 1200 1600 2000
 Scale in feet

U.S. Engineer Office, Omaha, Nebraska October, 1940

Submitted: _____ Approved: _____

Major, Corps of Engineers Lt. Col., Corps of Engineers

Compiled by	Traced by	Checked by	Transmitted with	File No.
F.H.	F.H.	R.R.V.	dated	A-4-2