

NISHNABOTNA CREEK DITCH LEVEE

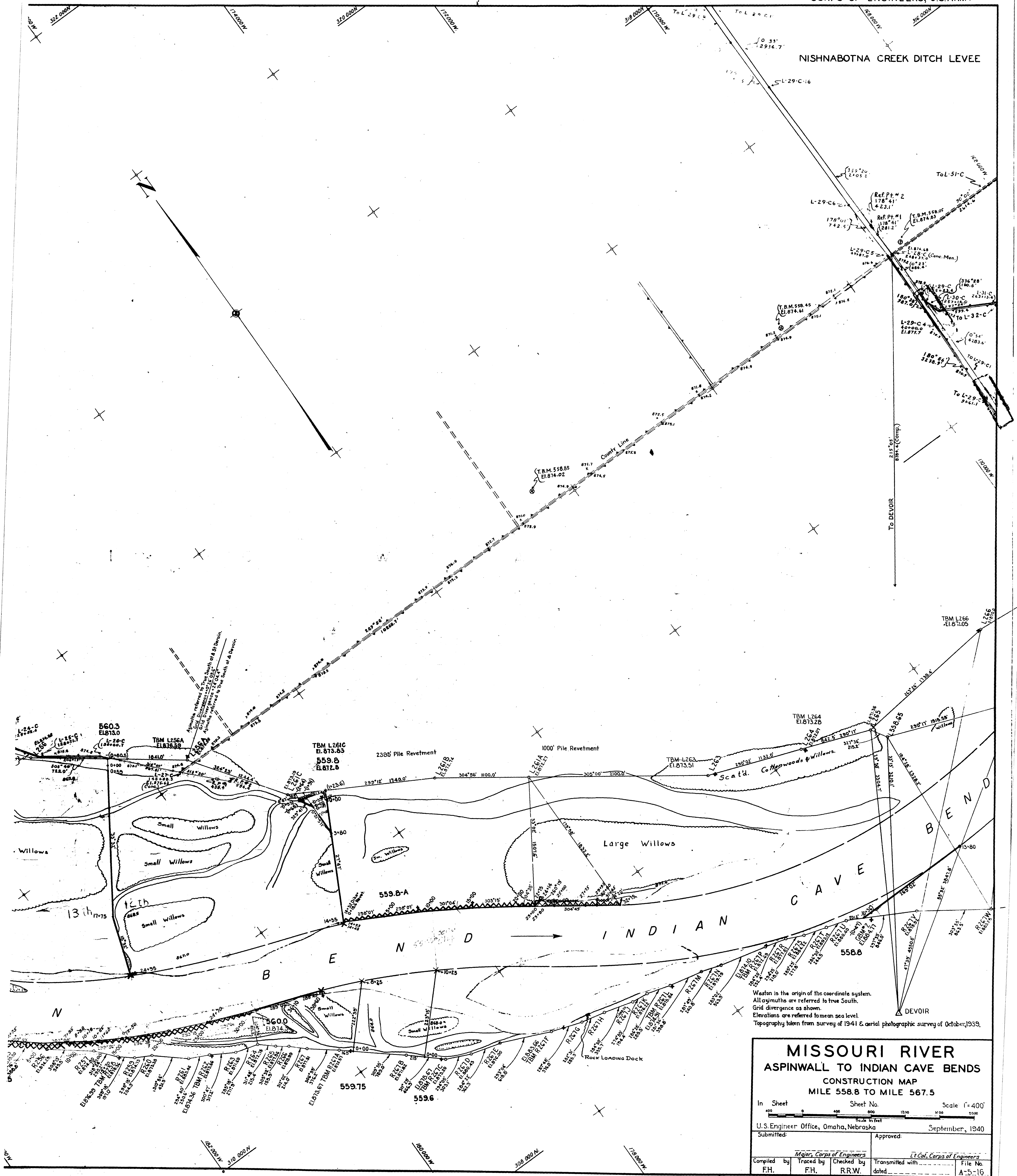

Weston is the origin of the coordinate system.  
 All azimuths are referred to true South.  
 Grid divergence as shown.  
 Elevations are referred to mean sea level.  
 Topography taken from survey of 1941 & aerial photographic survey of October, 1939.

**MISSOURI RIVER**  
**ASPINWALL TO INDIAN CAVE BENDS**  
 CONSTRUCTION MAP  
 MILE 558.8 TO MILE 567.5

In Sheet \_\_\_\_\_ Sheet No. \_\_\_\_\_ Scale 1"=400'  
 Scale in feet 0 400 800 1200 1600 2000

U.S. Engineer Office, Omaha, Nebraska September, 1940

Submitted:	Approved:
Compiled by _____ F.H.	Traced by _____ F.H.
Checked by _____ R.R.W.	Transmitted with _____ dated _____
Approved: _____ <i>Major, Corps of Engineers</i> Approved: _____ <i>Lt Col, Corps of Engineers</i>	
File No. _____ A-5-16	