

Δ Weston is the origin of coordinate system
 All azimuths on this sheet referred to true South Δ 223
 Grid divergence: 0° 19' 26.2"
 Soundings taken September 22, 1931
 Banklines & Bars September 22, 1931
 Elevations referred to Mean Sea Level as zero
 River Stage Sept. 22, below M.L.W. + 3.5'; below 1930 L.W.P. + 1.2'

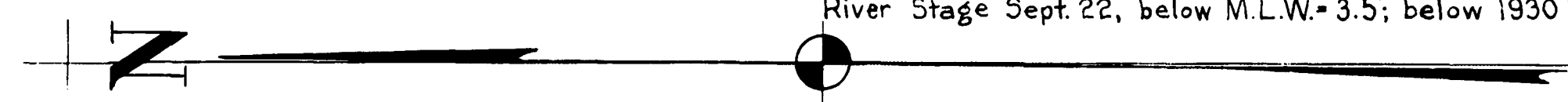

M I S S O U R I

NEBRASKA

COOPERATIVE NO.3 LEVEE

MISSOURI RIVER
ST. JOSEPH, MO. TO FLORENCE, NEB.
TOPOGRAPHIC SURVEY
MILE 544.8 TO MILE 546.7

72 Sheets Sheet No 23 Scale 1" = 400'
 U.S. Engineer Office, Kansas City, Missouri, July 14-17, 1931

Submitted: *W. J. Fencor* Approved: *W. J. Fencor*
 256-23 date: 1931

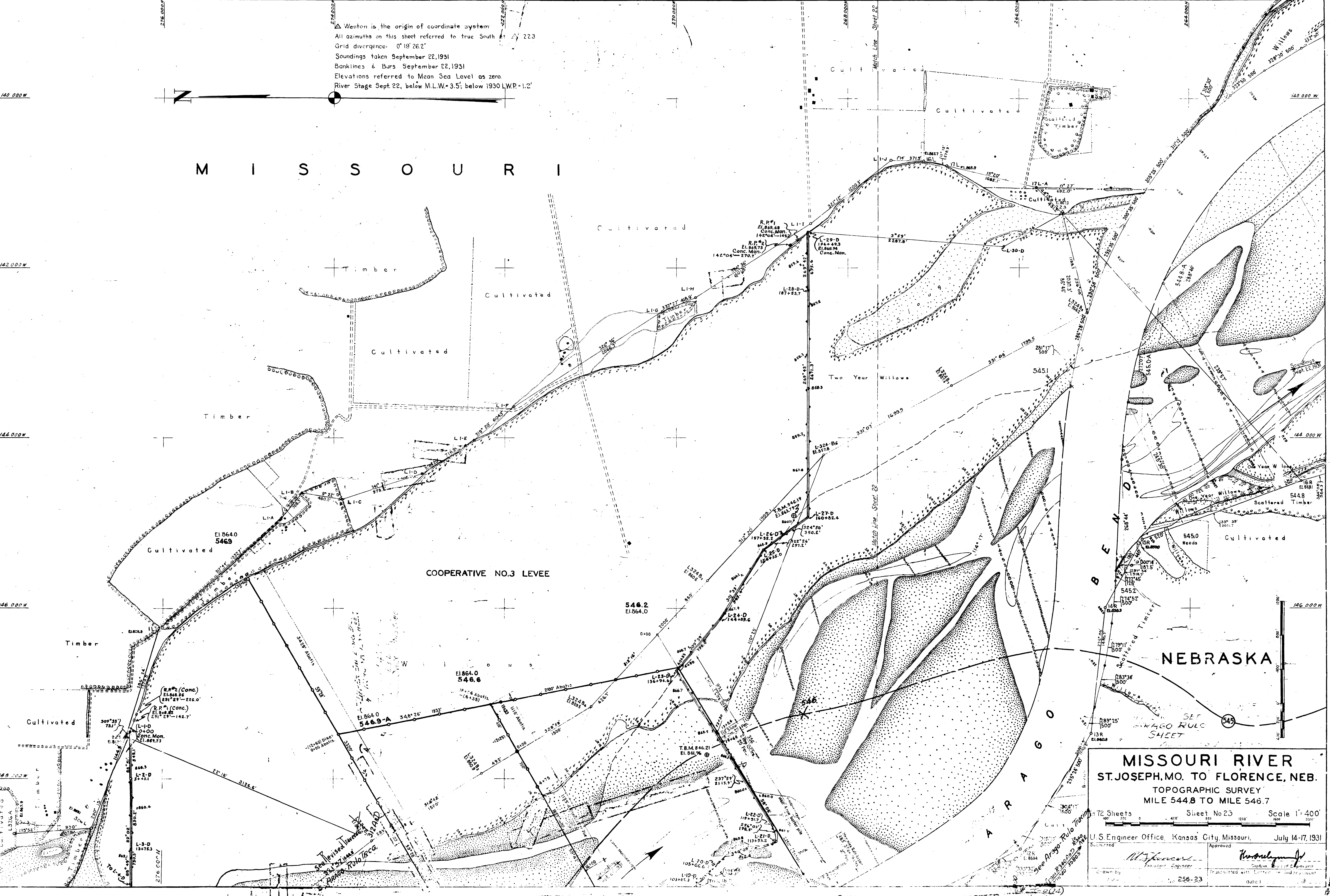

140 000 W 142 000 W 144 000 W 146 000 W

27 28