

HARRISON COUNTY

J O W A

LITTLE SIOUX REACH

N E B U R K A S K A

B U R T C O U N T Y

DATE		DESCRIPTION	DATE	APPROVED
Revised to show latest field data				
U. S. ARMY ENGINEER DISTRICT, OMAHA CORPS OF ENGINEERS OMAHA, NEBRASKA				
COMPILED BY: M. E. B.	MISSOURI RIVER			
DRAWN BY: M. E. B.	PONCA BEND TO RULO BEND			
CHECKED BY: J. C. C. S.	STRUCTURE 727.65 TO 724.62			
SUBMITTED BY: <i>[Signature]</i>	UPPER LITTLE SIOUX REACH TO			
ENGINEER: <i>[Signature]</i>	LOWER LITTLE SIOUX REACH			
RECOMMENDED BY: <i>[Signature]</i>	APPROVED: <i>[Signature]</i>	DATE: APR 1974		
CHIEF HYDRO ENG. BRANCH	CHIEF ENGINEERING DIVISION		SCALE 1"=1000 FEET	
M 400/61				

NOTES:
 ▲ WESTON IS THE ORIGIN OF THE GRID COORDINATE SYSTEM.
 ALL AZIMUTHS ON THIS SHEET REFER TO TRUE SOUTH AT ▲ AS SHOWN.
 GRID DIVERGENCE AS SHOWN.
 ELEVATIONS REFER TO MEAN SEA LEVEL AS ZERO.
 O 1000 ADJUSTED MILEAGE.
 1000 MILEAGE SHOWN IN TITLE.
 ◆ BEND CHANGE

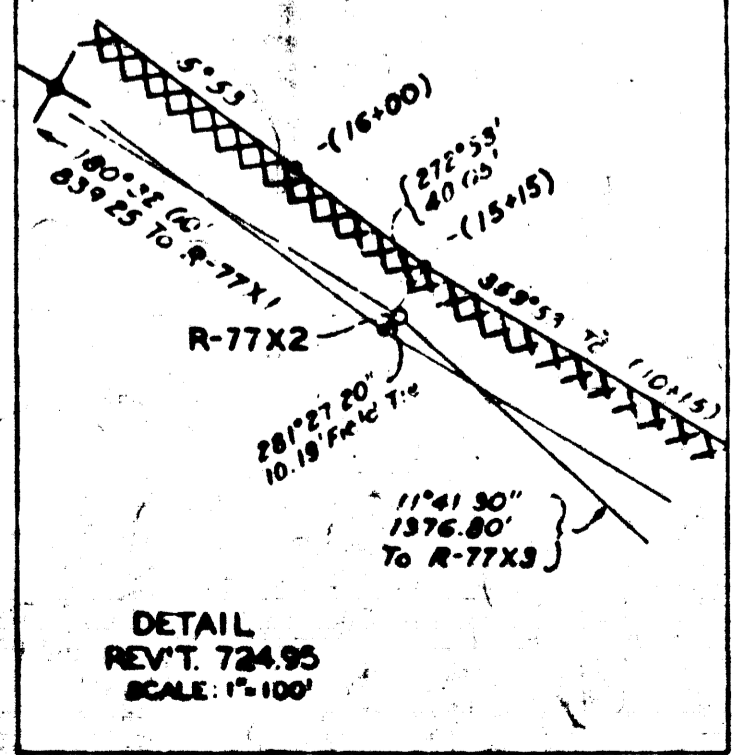

ALL AZIMUTHS REFERRED TO
TRUE SOUTH AT ▲ 381
GRID DIVERGENCE 4° 47' 47.4"

1 Oct, 1968 30 Oct, 1968
Banklines

TRUE SOUTH AT ▲ 380 TRUE SOUTH AT ▲ 389
GRID DIVERGENCE 0° 46' 0.7" GRID DIVERGENCE 0° 48' 14.2"

STA 1106 TO STA 2190
STA 2190 TO STA 3440 GRADUAL DROP FROM EL 1024.2 TO 1023.2
STA 3440 TO STA 4140
STA 4140 TO STA 4770 GRADUAL RISE FROM EL 1023.2 TO 1024.2
STA 4770 TO STA 5100 EL 1024.2

