

P O T T A W A T T A M I E C O U N T Y

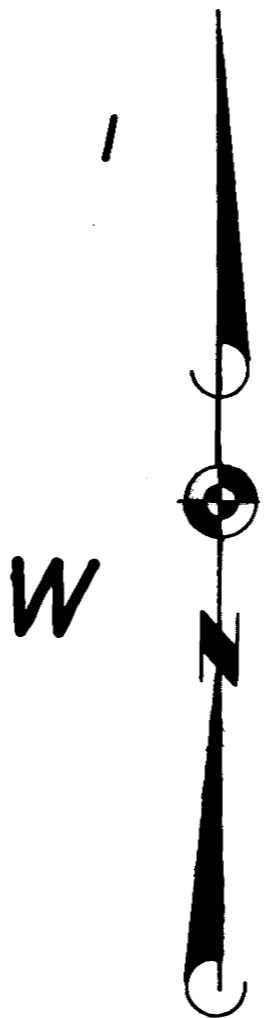

BANKLINES
12 OCT. 1964

VANMAN LEVEE

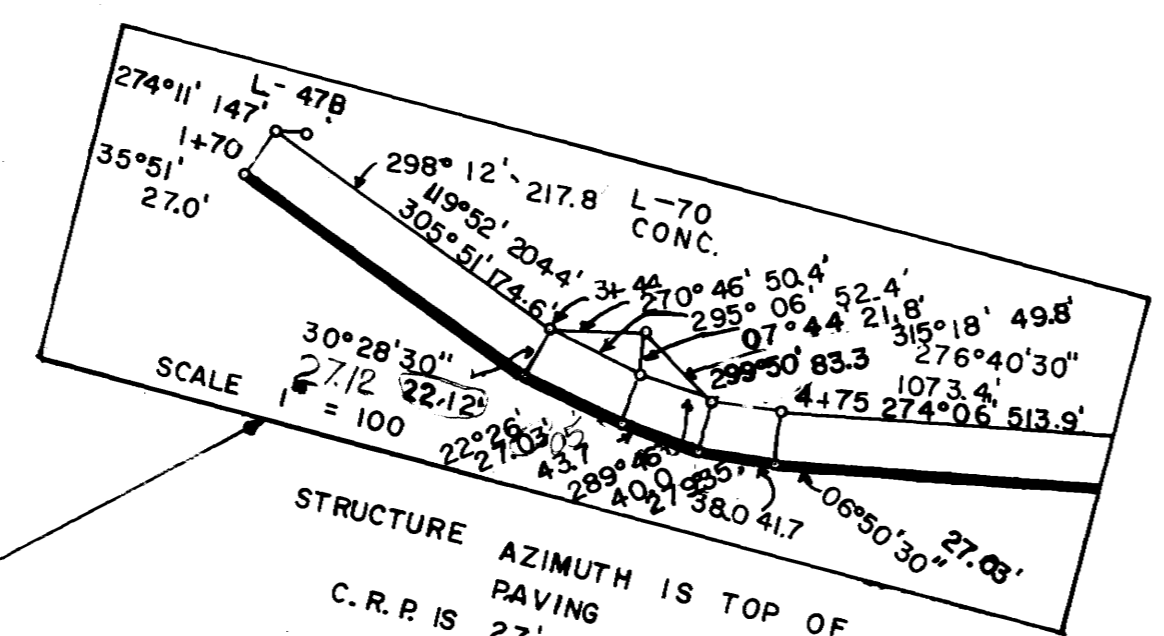

STRUCTURE AZIMUTH IS TOP OF
PAVING
C.R.R IS 27' RIVERWARD

682.4 REV.

L-70(RESET)
CONC.

L-639.4

L-639.5

L-638.9

L-638.8

L-638.7

L-638.6

L-638.5

STATE OF IOWA
BOAT RAMP

B E N D

M I D D L E

C A L H O U N

B E N D

L O W E R

C A L H O U N

W A S H I N G T O N C O U N T Y

N E B R A S K A

756000
754000
752000
750000
748000
746000

302.000 W 300.000 W 298.000 W 296.000 W 294.000 W

MISSOURI RIVER BANK
State Surveyors Office, State of Nebr.
Taken From U.S. Army Engineer Plans
Showing Section Lines, Date JAN. 1964
Sheet No. 64 Scale 1"=400'